

1
5.1 QUADRANT ELEVATION @ PNL SIDE
SC-1 1/2" = 1'-0"

CONTRACTOR TO VERIFY ALL FIELD CONDITIONS PRIOR TO FABRICATION AND INSTALLATION

Submission No.	Job No. 201425
<input type="checkbox"/> Approved	<input type="checkbox"/> Information Only
<input checked="" type="checkbox"/> Approved As Corrected	
<input type="checkbox"/> Revise And Resubmit	
<input type="checkbox"/> Rejected	

Architect's review is only for general conformance with the design concept of the project and general compliance with the information given in the Contract Documents. Corrections or comments given made on the shop drawing during this review do not relieve contractor from compliance with the requirements of the plans and specifications. Approval of a specific item shall not include approval of an assembly of which the item is a component. Contractor is responsible for: dimensions to be confirmed and correlated at the job site; information that pertains solely to the fabrication processes or to the means, methods, techniques, sequences and procedures of construction; coordination of the Work of all trades and for performing all work in a safe and satisfactory manner.

José Carballo Architectural Group, P.C.
Date: 03/16/2017
Checked By: **ELI DRESLER**

RECEIVED
By OneKey LLC at 3:10 pm, Mar 20, 2017

RECEIVED
By OneKey LLC at 8:34 am, Mar 13, 2017

CHEYENNE CO LLC 68 EAST DUDLEY TOWN ROAD BLOOMFIELD, CT 06002 (T) (800) 676-8840 (F) (866) 676-3188 sales@cheyennecompany.com www.cheyennecompany.com		CHEYENNE <i>Leaders in Composite Fabrications</i>																									
PROJECT PONEMAH MILL LOCATION 607 NORWICH AVENUE TAVILLE, CT 06380 ARCHITECT JCA RIVER EDGE, NJ 07661 CONTRACTOR X		DISTRIBUTION OF COPIES <table border="1"> <tr> <th>Date</th> <th>Copies</th> <th>Date</th> <th>Copies</th> </tr> <tr> <td>G.C.</td> <td>X</td> <td>PDF</td> <td>X</td> </tr> <tr> <td>ARCH.</td> <td>X</td> <td>PDF</td> <td>X</td> </tr> <tr> <td>SHOP</td> <td>3/9/17</td> <td>PDF</td> <td>X</td> </tr> <tr> <td>NO.</td> <td>DATE</td> <td>REVISIONS</td> <td></td> </tr> <tr> <td>X</td> <td>X</td> <td>X</td> <td>X</td> </tr> </table>		Date	Copies	Date	Copies	G.C.	X	PDF	X	ARCH.	X	PDF	X	SHOP	3/9/17	PDF	X	NO.	DATE	REVISIONS		X	X	X	X
Date	Copies	Date	Copies																								
G.C.	X	PDF	X																								
ARCH.	X	PDF	X																								
SHOP	3/9/17	PDF	X																								
NO.	DATE	REVISIONS																									
X	X	X	X																								
TITLE OCTAGON ELEVATION @ PNL SIDE		MISCELLANEOUS NOTES * IF ALL DIMENSIONS																									
BY HM Ref. Dwg. Date 1.5" = 1'-0" 3/10/17 DWG. No. 5.2		EXCLUSIONS E1 E2 E3 E4 E5 E6 E7 E8 E9 E10 E11 E12																									
MATERIALS M1 M2 M3 M4 M5 M6 M7 M8 M9 M10 M11 M12 M13 M14		REVISIONS R1 R2 R3 R4 R5 R6 R7 R8 R9 R10 R11 R12 R13 R14																									

RECEIVED
By OneKey LLC at 10:11 am, Mar 23, 2017

Submission No. _____ Job No. 201245

- Approved
 Approved As Corrected
 Revise And Resubmit
 Rejected Information Only

Architect's review is only for general conformance with the design concept of the project and general compliance with the information given in the Contact Documents. Corrections or comments given made on the shop drawing during this review do not relieve contractor from compliance with the requirements of the plans and specifications. Approval of a specific item shall not include approval of an assembly of which the item is a component. Contractor is responsible for: dimensions to be confirmed and correlated at the job site; information that pertains solely to the fabrication processes or to the means, methods, techniques, sequences and procedures of construction; coordination of the Work of all trades and for performing all work in a safe and satisfactory manner.

José Carballo Architectural Group, P.C.
03/23/2017

Date: _____

Checked By: Eli Dresler

Contractor to confirm all dimensions prior to fabrications and installations
 Contractor to review and address all field conditions for proper installation
 Contractor to remove and replace any damaged material such as backing that will effect the installation

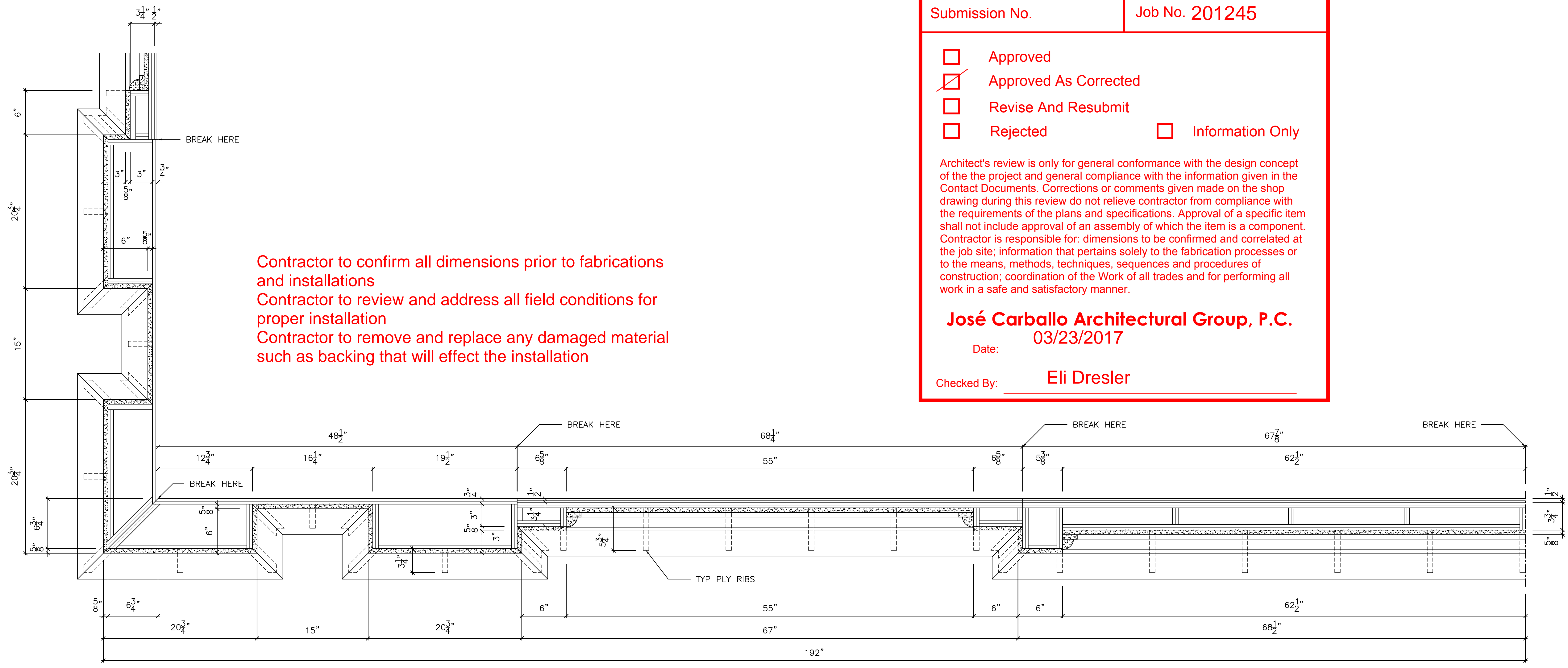

A PLAN SECTION
4.0 SC-1 1/2"=1'-0"

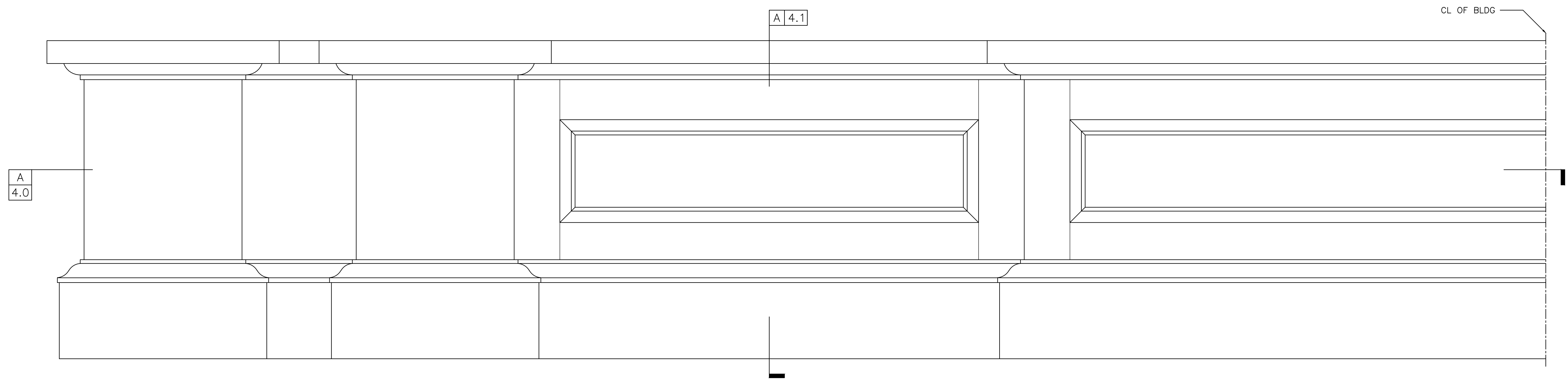

1 FRONT ELEVATION
4.0 SC-1 1/2"=1'-0"

MATERIALS

M1	x
M2	x
M3	x
M4	x
M5	x
M6	x
M7	x
M8	x
M9	x
M10	x
M11	x
M12	x
M13	x
M14	x

EXCLUSIONS

E1	x
E2	x
E3	x
E4	x
E5	x
E6	x
E7	x
E8	x
E9	x
E10	x
E11	x
E12	x

MISCELLANEOUS NOTES

• MAKE 8 (EIGHT) TOTAL WINDOWS

x	
x	
x	
x	
x	
x	
x	
x	
x	
x	
x	
x	
x	
x	
x	
x	
x	
x	
x	

DISTRIBUTION OF COPIES

	Date	Copies	Date	Copies
G.C.	3/1/17	PDF	x	PDF
ARCH.	3/1/17	PDF	x	PDF
SHOP	3/1/17	PDF	x	PDF

NO.	DATE	REVISIONS
x	x	X
x	x	X



CHEYENNE CO LLC
 68 EAST DUDLEY TOWN ROAD
 BLOOMFIELD, CT 06002
 (T) (800) 676-8840
 (F) (866) 676-3188
 sales@cheyennecompany.com
 www.cheyennecompany.com

PROJECT
 PONEMAH MILL
LOCATION
 607 NORWICH AVENUE
 TAFTVILLE, CT 06380

ARCHITECT
 JCA
 RIVER EDGE, NJ 07661

CONTRACTOR
 x
 x

TITLE
 PANELS
 FRONT ELEVATION

By	Scale	Dwg. No.
HM	FULL SIZE	4.0
Ref. Dwg.	Date	
1.804/08/21	3/1/17	

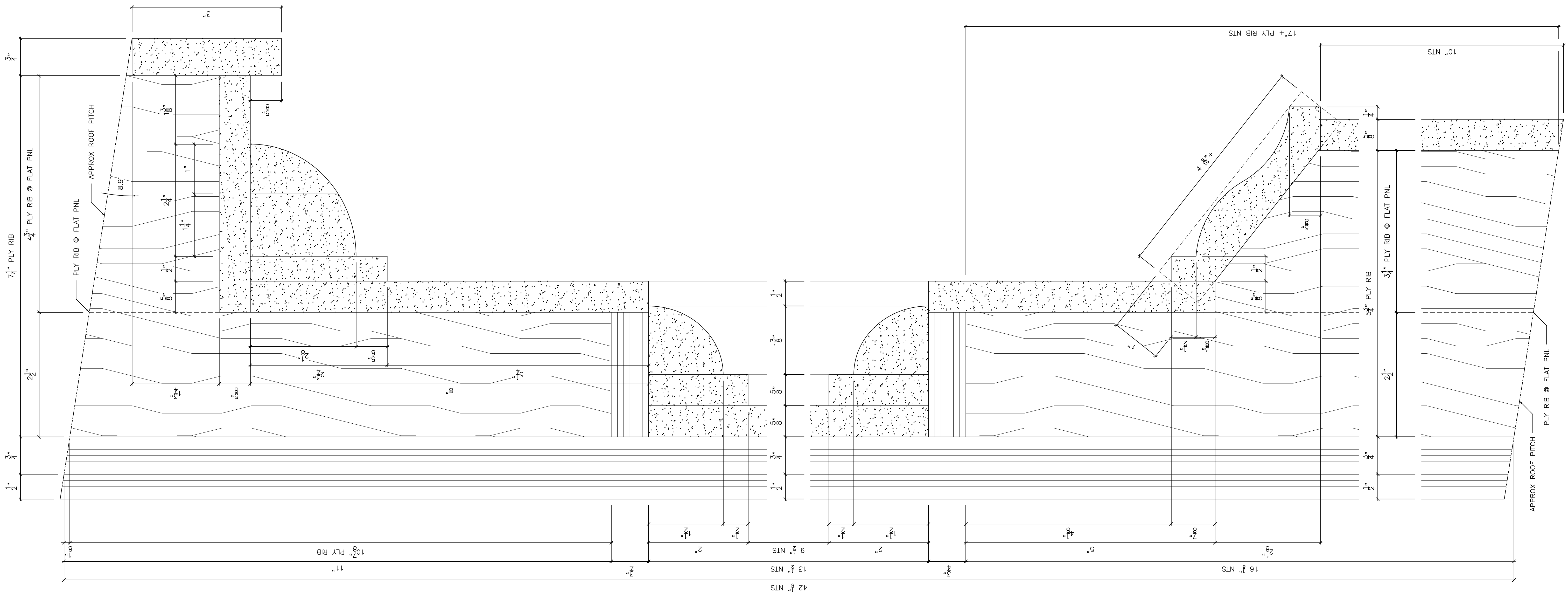

MATERIALS	
M1	x
M2	x
M3	x
M4	x
M5	x
M6	x
M7	x
M8	x
M9	x
M10	x
M11	x
M12	x
M13	x
M14	x

EXCLUSIONS	
E1	x
E2	x
E3	x
E4	x
E5	x
E6	x
E7	x
E8	x
E9	x
E10	x
E11	x
E12	x

MISCELLANEOUS NOTES	
• MAKE 8 (EIGHT) TOTAL WINDOWS	
x	
x	
x	
x	
x	
x	
x	
x	
x	
x	
x	
x	
x	
x	
x	
x	
x	
x	
x	

DISTRIBUTION OF COPIES				
	Date	Copies	Date	Copies
G.C.	3/1/17	PDF	x	PDF
ARCH.	3/1/17	PDF	x	PDF
SHOP	3/1/17	PDF	x	PDF
NO.	DATE	REVISIONS		
x	x	X		
x	x	X		



CHEYENNE CO LLC
 68 EAST DUDLEY TOWN ROAD
 BLOOMFIELD, CT 06002
 (T) (800) 676-8840
 (F) (866) 676-3188
 sales@cheyennecompany.com
 www.cheyennecompany.com

PROJECT
 PONEMAH MILL
LOCATION
 607 NORWICH AVENUE
 TAFTVILLE, CT 06380

ARCHITECT
 JCA
 RIVER EDGE, NJ 07661

CONTRACTOR
 X
 X

TITLE
 PANELS
 VERTICAL SECTION

By	Scale	Dwg. No.
HM	FULL SIZE	4.1
Ref. Dwg.	Date	
1.804/08/21	3/1/17	

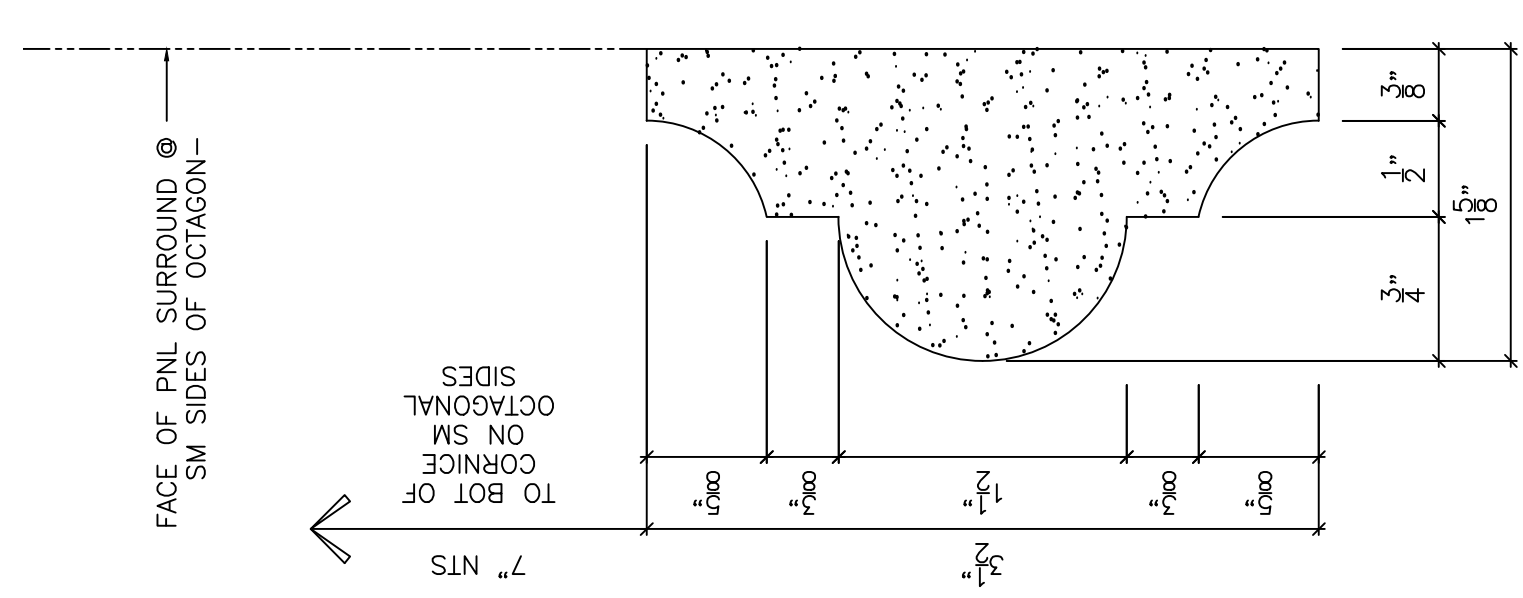
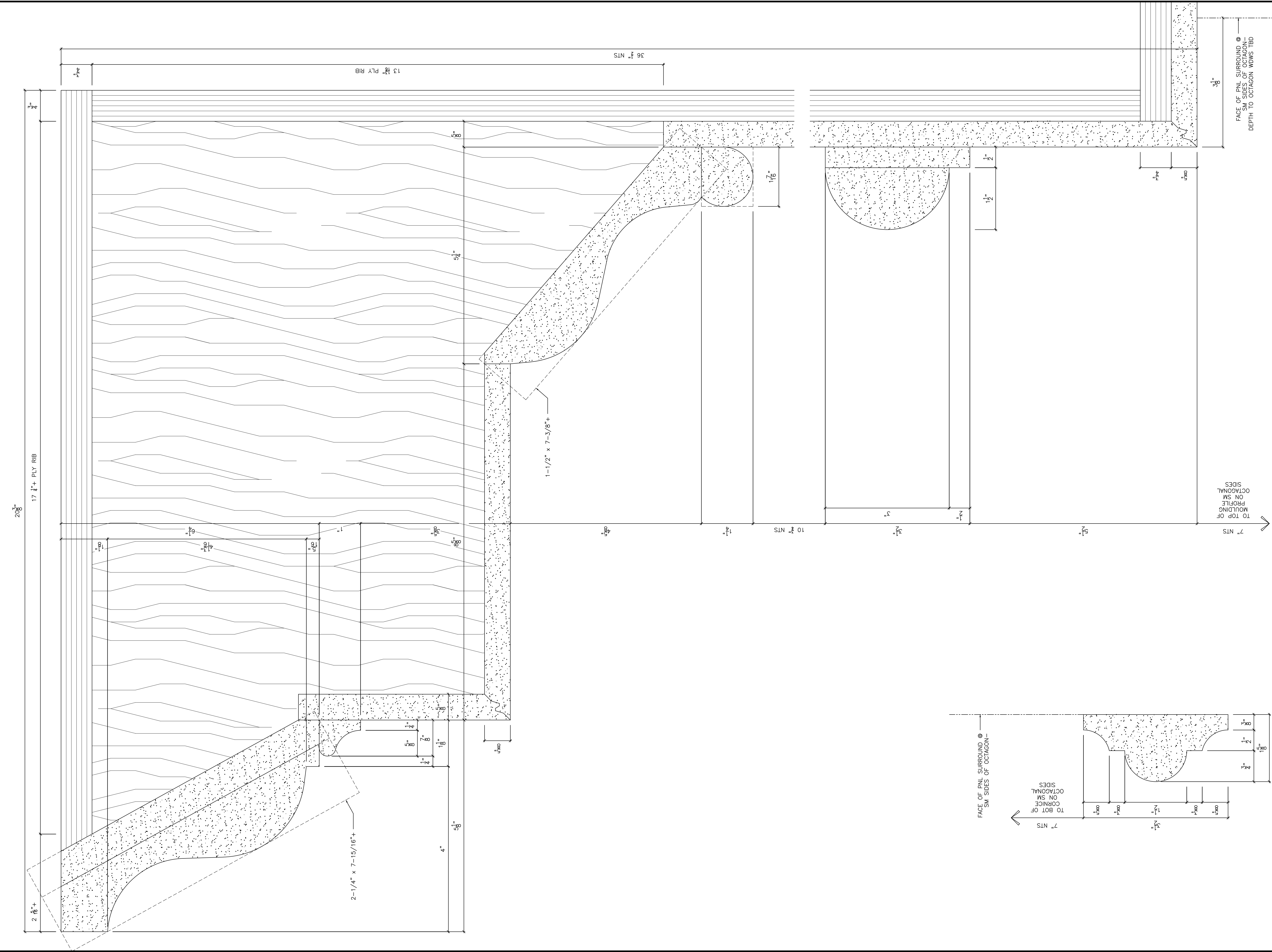

D1 VERTICAL SECTION @ PNL Moulding ON SM OCTAGONAL SIDES
5.0 SC-FULL SIZE

MATERIALS	
M1	x
M2	x
M3	x
M4	x
M5	x
M6	x
M7	x
M8	x
M9	x
M10	x
M11	x
M12	x
M13	x
M14	x

EXCLUSIONS	
E1	x
E2	x
E3	x
E4	x
E5	x
E6	x
E7	x
E8	x
E9	x
E10	x
E11	x
E12	x

MISCELLANEOUS NOTES	
• MAKE 8 (EIGHT) TOTAL WINDOWS	
x	
x	
x	
x	
x	
x	
x	
x	
x	
x	
x	
x	
x	
x	
x	
x	
x	
x	
x	
x	
x	
x	
x	

DISTRIBUTION OF COPIES				
	Date	Copies	Date	Copies
G.C.	x	PDF	x	PDF
ARCH.	x	PDF	x	PDF
SHOP	3/2/17	PDF	x	PDF
NO.	DATE	REVISIONS		
x	x	x		
x	x	x		



CHEYENNE CO LLC
68 EAST DUDLEY TOWN ROAD
BLOOMFIELD, CT 06002
(T) (800) 676-8840
(F) (866) 676-3188
sales@cheyennecompany.com
www.cheyennecompany.com

PROJECT
PONEMAH MILL
LOCATION
607 NORWICH AVENUE
TAFTVILLE, CT 06380

ARCHITECT
JCA
RIVER EDGE, NJ 07661

CONTRACTOR
x
x

TITLE
CORNICE
VERTICAL SECTION

By HM	Scale FULL SIZE	Dwg. No. 5.0
Ref. Dwg. 1.804/08/21	Date 3/2/17	

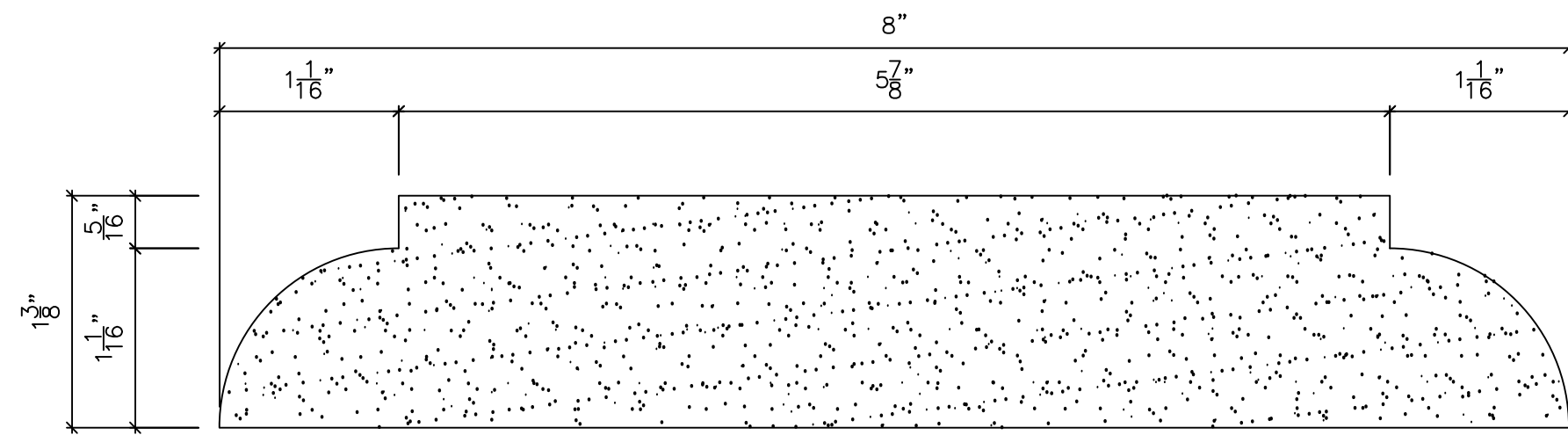

D1 SECTION @ PIECE BETWEEN WDWS ON LARGE OCTAGONAL SIDES
6.0 SC-FULL SIZE

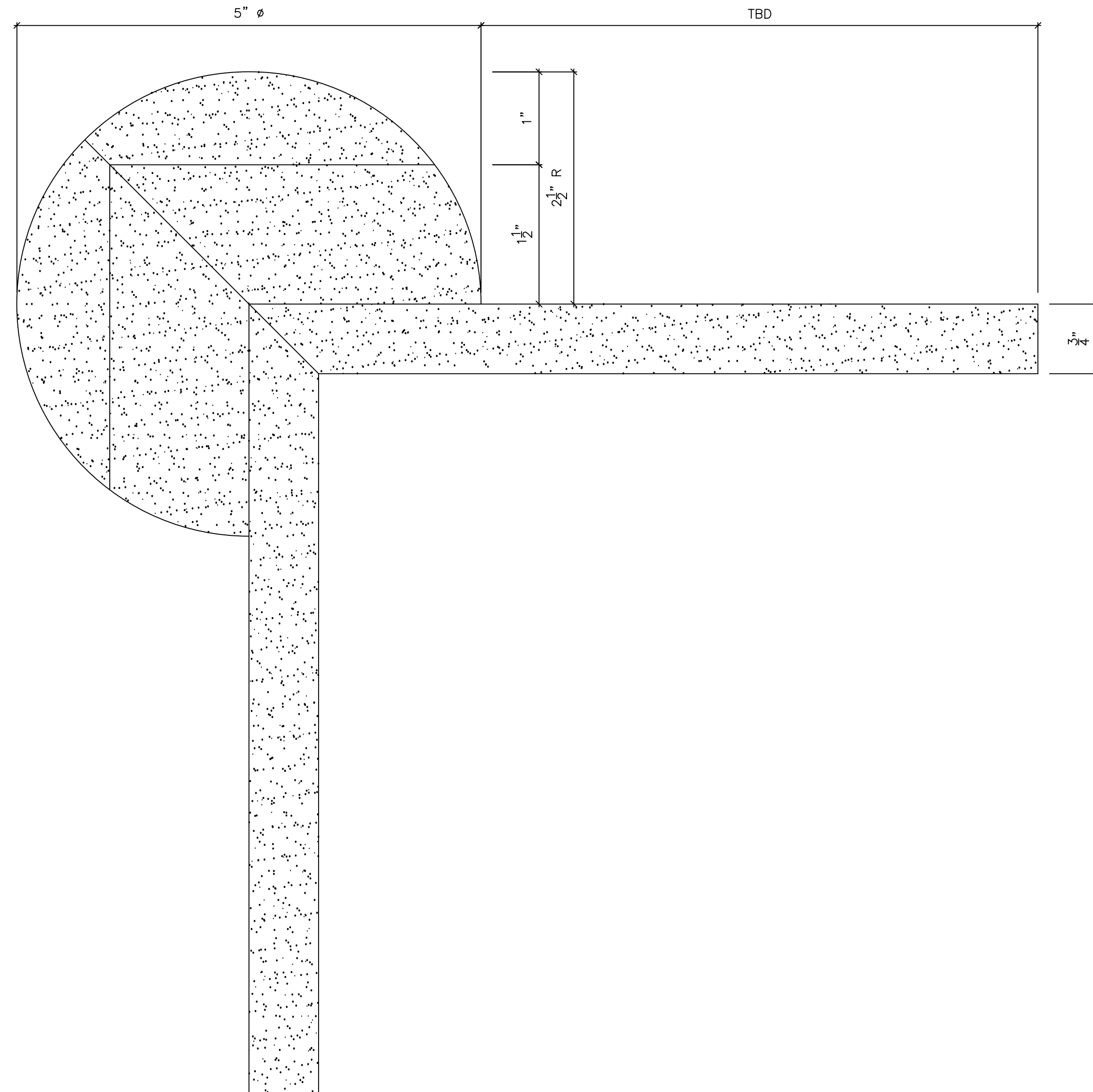

D2 SECTION @ ROOF RIDGE ASSEMBLY
6.0 SC-FULL SIZE

MATERIALS

M1	x
M2	x
M3	x
M4	x
M5	x
M6	x
M7	x
M8	x
M9	x
M10	x
M11	x
M12	x
M13	x
M14	x

EXCLUSIONS

E1	x
E2	x
E3	x
E4	x
E5	x
E6	x
E7	x
E8	x
E9	x
E10	x
E11	x
E12	x

MISCELLANEOUS NOTES

• MAKE 8 (EIGHT) TOTAL WINDOWS

- x
- x
- x
- x
- x
- x
- x
- x
- x
- x
- x
- x
- x
- x
- x
- x
- x
- x
- x
- x

DISTRIBUTION OF COPIES

	Date	Copies	Date	Copies
G.C.	x	PDF	x	PDF
ARCH.	x	PDF	x	PDF
SHOP	3/2/17	PDF	x	PDF

NO.	DATE	REVISIONS
x	x	X
x	x	X



CHEYENNE CO LLC
68 EAST DUDLEY TOWN ROAD
BLOOMFIELD, CT 06002
(T) (800) 676-8840
(F) (866) 676-3188
sales@cheyennecompany.com
www.cheyennecompany.com

PROJECT
PONEMAH MILL
LOCATION
607 NORWICH AVENUE
TAFTVILLE, CT 06380

ARCHITECT
JCA
RIVER EDGE, NJ 07661

CONTRACTOR
x
x

TITLE
ASSORTED PROFILES
x

By	Scale	Dwg. No.
HM	FULL SIZE	6.0
Ref. Dwg.	Date	
1.804/08/21	3/2/17	